

L.R.NO : 03/2016/VJA.
FILE NO : 1/TPO/1110/2015.

LAY-OUT PLAN IN R.S.No:- 45/3F;
46/1(P), 2(P), 3 AND 47/5B, 5C OF
JAMI NEVEPOTHAVARAM VILLAGE,
IBRAHIMPATNAM MANDAL,
KRISHNA DISTRICT.
(WITH MORTGAGE)

REFERENCE

BOUNDARY OF THE LAY-OUT	
BOUNDARY OF SUB-DIVISIONS	
BOUNDARY OF R.S. NUMBERS	
EXISTING ROADS	
PROPOSED ROADS	
OPEN SPACE	
APPLICANT'S SITE US TO BE DISPOSED	
GREEN BELT	
MORTGAGED PLOTS	
AREA OF THE LAY-OUT	Ac 13.86 25 Cts.
ROADS AREA (34.37%)	Ac 04.76 51 Cts.
OPEN SPACE AREA (10.03%)	Ac 01.39 03 Cts.
PLOTTED AREA (55.25%)	Ac 07.67 28 Cts.
GREEN BELT (06.25%)	Ac 00.03 43 Cts.
NUMBER OF PLOTS	174.
MORTGAGED PLOTTED AREA (15.14% ON TOTAL PLOTTED AREA)	Ac 1.16 56 Cents.
SPRAY	
AT 40' WIDE ROAD JUNCTIONS	3.0 M X 3.0 METERS
RAIN WATER HARVESTING STRUCTURE :	
7.00 X 4.00 X 1.50 METERS - 1 No	
EXISTING ELECTRICAL LINES ARE TO :	
BE SHIFTED ALONG THE ROAD MARGINS	

NOTE: 1. PLOT NUMBERS 1 TO 8, 11 TO 18, 23 TO 28 AND 34 ARE MORTGAGED TO A P.C.R.D.A WIDE REGISTERED MORTGAGE DEED NUMBER:- 504/2016; DATED-02-02-2016.
2. PLOT NUMBERS 35, 76, 77, 79 ARE RESERVED FOR LAY-OUT CENTER AC 0.34 38 CENTS - (02.51%)

ANDHRA PRADESH CAPITAL REGION DEVELOPMENT AUTHORITY, VIJAYAWADA.

A. SRI KANT, I.A.S
CONTROLLER GENERAL

A. HANUJAN LAKSHMI RAO, I.A.S
ADDITIONAL COMMISSIONER



[Signature]
DIRECTOR (DEVELOPMENT CONTROL)

[Signature]
DEPUTY DIRECTOR

SCALE
1" : 66' 0"

[Signature]
TOWN PLANNING OFFICER

A.A.D.H

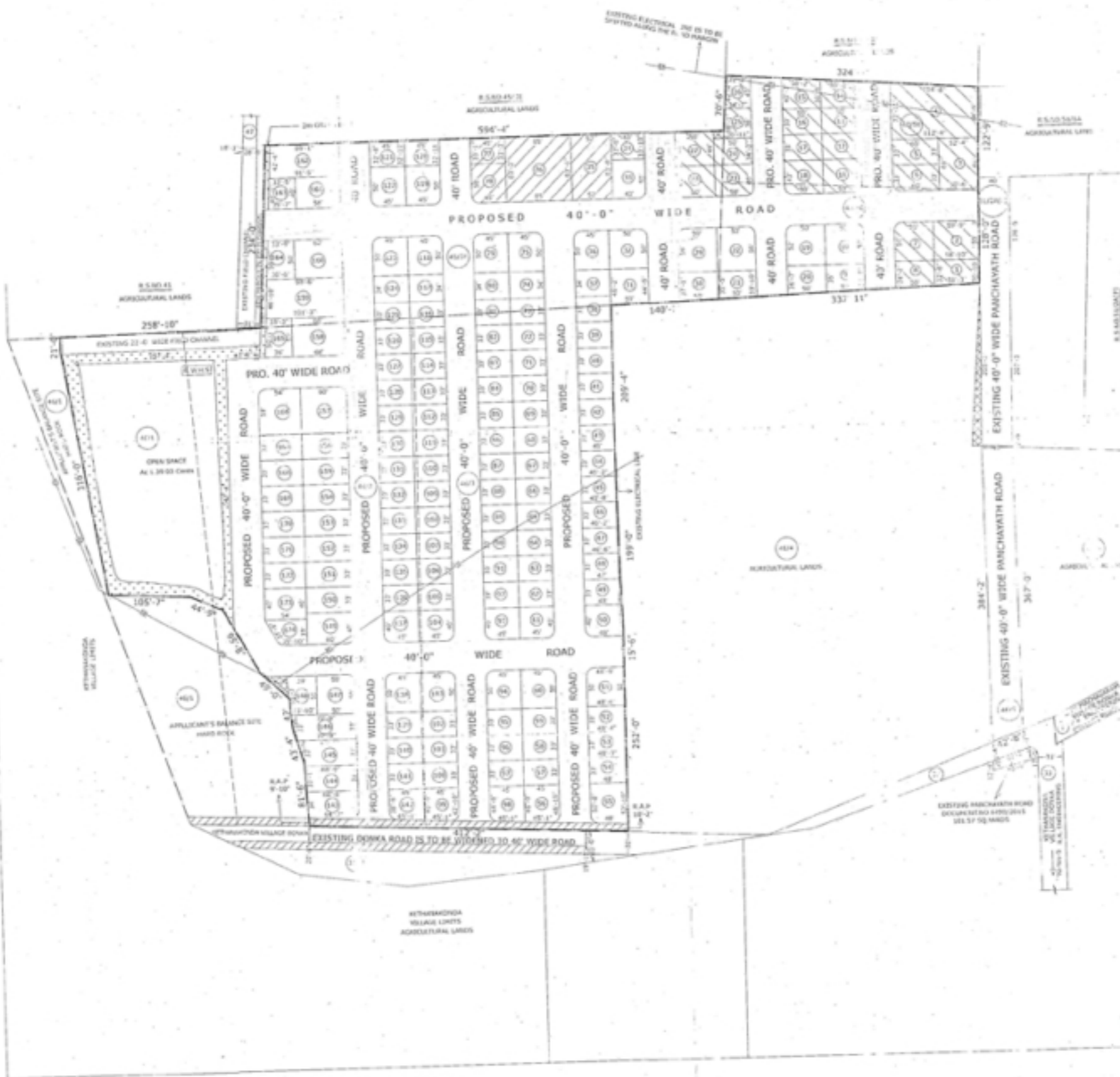

location map
(not to scale)



Idyllic site with commercial prospects of Vijayawada and inspiring environment of new capital Amaravathi

